

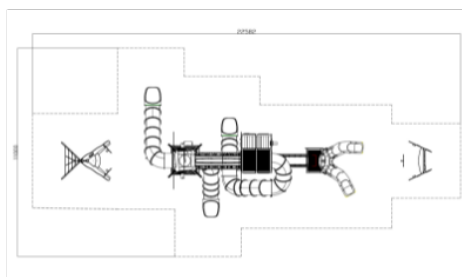

Have you seen any similar structure, with three height platforms and with outstanding spiral slides that take your breath away? The **BIG-Towers** is a bet for the most exciting games, those where the child can get lost and get focused on new adventures. They can get personalized with an appropriate theme to its surrounding. Can illustrate from big castels, take a trip to Egiptians culture or discover the marine world.



A=22582mm m² m
B=11000mm

SB

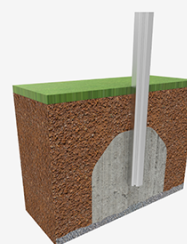

[HD image](#)

Materials:

Structure, Aluminium: The structural profiles used are 6005 cold extruded alloy, 2.5 mm thick. They are extremely strong and offer excellent resistance to corrosion. After extrusion, the poles are varnished with a non-toxic lead-free powder paint. All the aluminum profiles have special constructions in the grooves in which the connecting bolts are inserted for extra durability and greater anti-vandal resistance.

Panels, HDPE: High-density polyethylene characterized by its resistance to chemical abrasives and unaffected by corrosion as it is a polymer. Due to its light, elastic nature, it offers high resistance to impact, making it very difficult to break.

Metallic parts: Stainless steel AISI-304, hot-dip galvanized steel and aluminium.

Fixings: Electro galvanized and stainless steel quality 8.8 DIN267, AISI-304.

- For a very severe use of the equipment should increase inspection / maintenance.
- Don't use the product before the installation/maintenance is ready.
- Please check the maintenance instructions.

The biggest part (mm): 3340x40x40 / Maximum weight of parts (kg): 44

IMPACT ZONE: Required security area. Ground coverings according to the norm EN1176-1:2017 are recommended.
Spare parts/replacements availability: 10 years.

Ground anchoring screws not included.

Playful features:

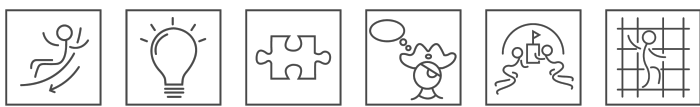

Alternatives:

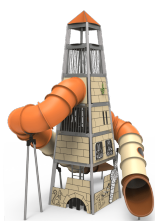

[JTEM03](#)

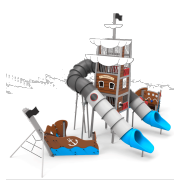

[JTEM06](#)



[JTEM02](#)



[JTEM01](#)

Projects:

